

REV	ECN NO	REVISIONS	DRN	CKD	APP	DATE
A		NEW RELEASE	TWC			

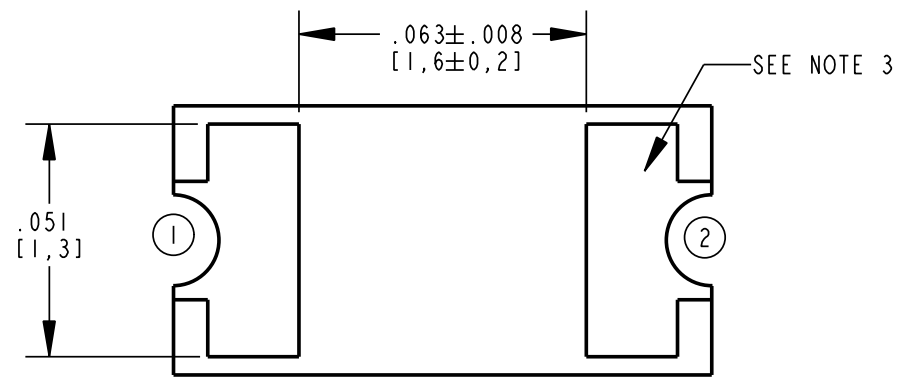

ATTENTION:
OBSERVE PRECAUTIONS FOR
HANDLING ELECTROSTATIC
SENSITIVE DEVICES

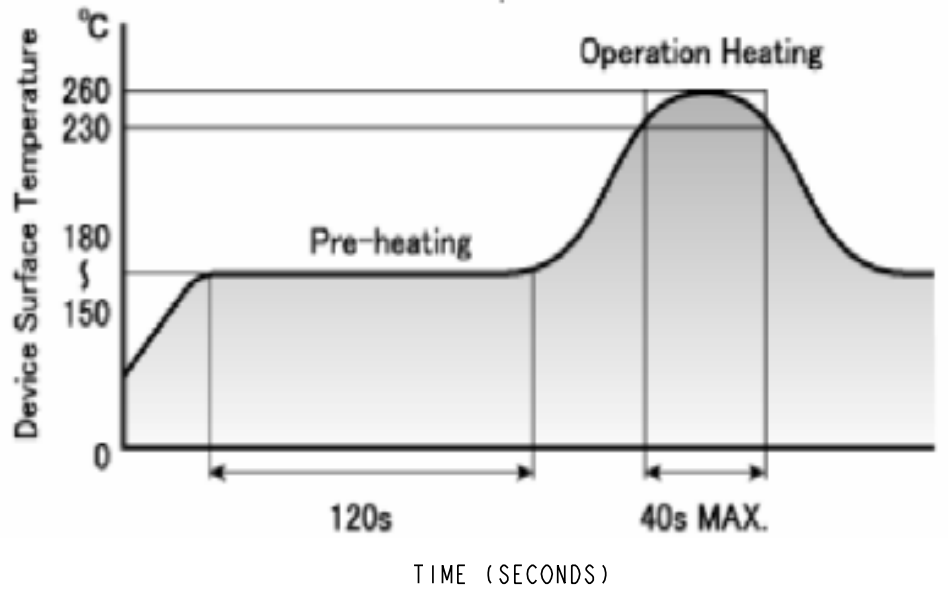
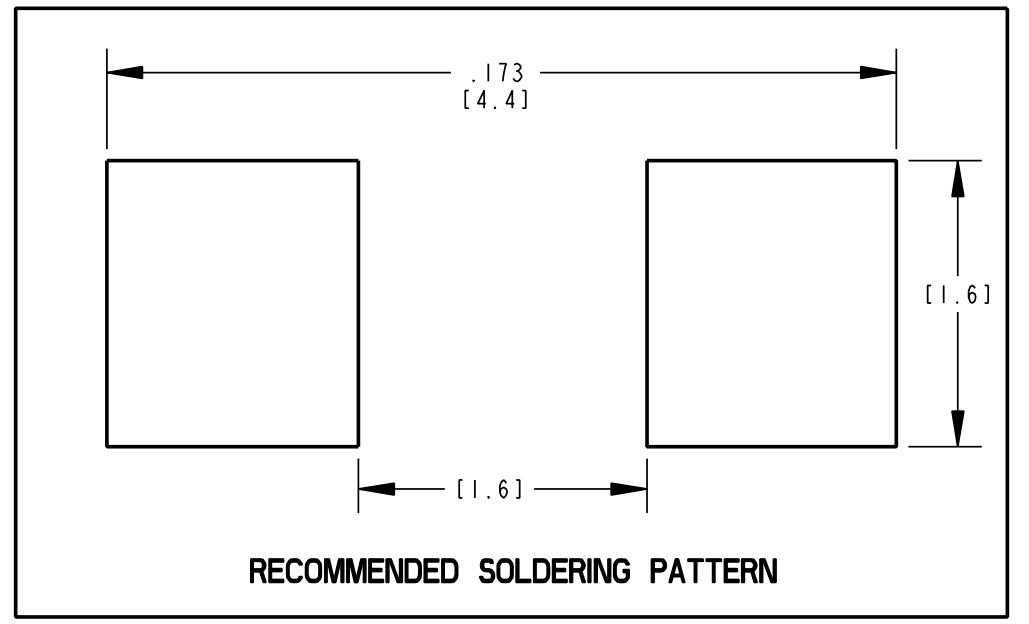
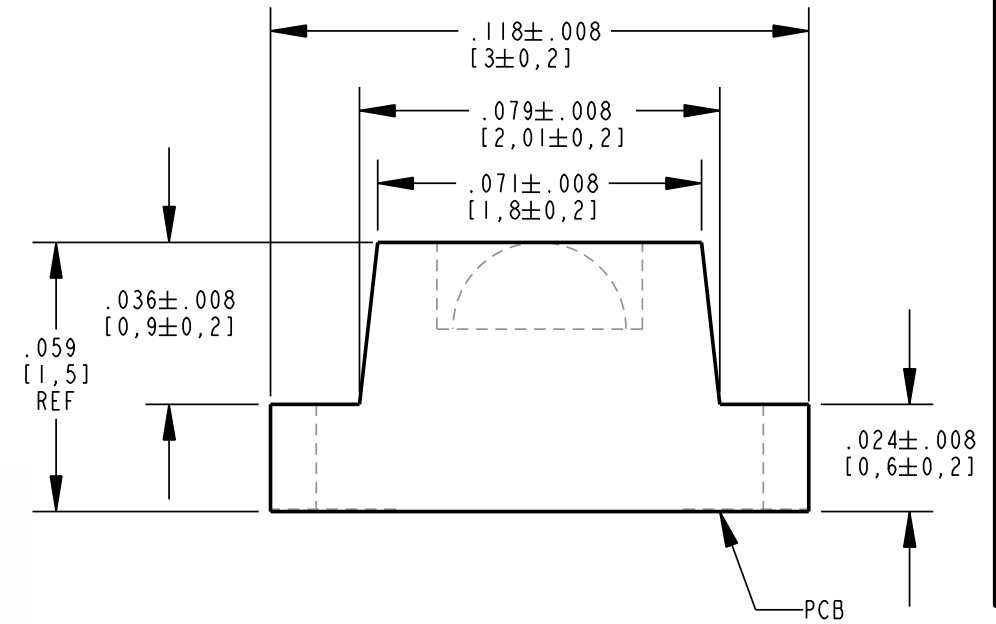
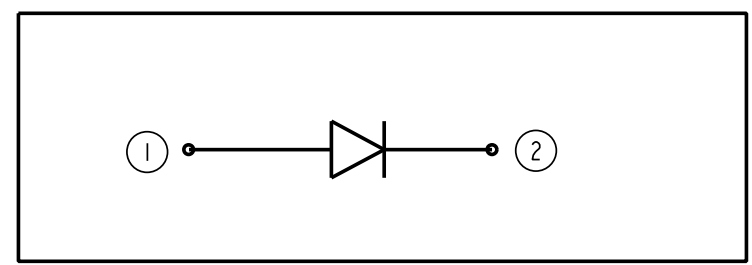
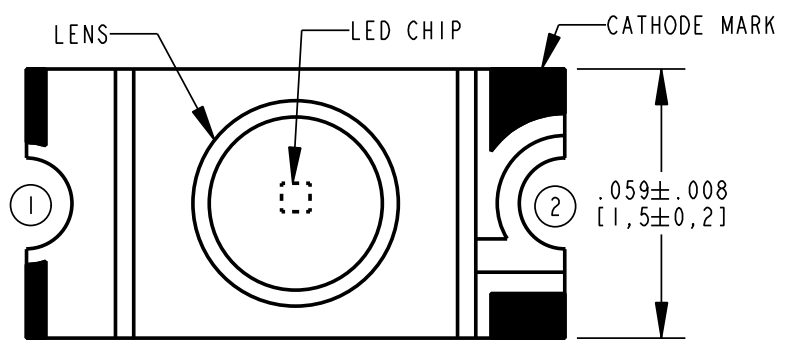

NOTES:

1. DIE InGaN BLUE 470nm
2. EPOXY COLOR: WATER CLEAR
3. LEADS GOLD (Au) PLATED
4. PACKAGING: TAPE 8MM WIDTH 180MM (7") REEL, 2500 PCS./REEL, IN AN ANTI-STATIC BAG WITH MS LEVEL "3" LABEL OR EQUIVALENT AS PER JEDEC STD. J-STD-033
5. PARTS ARE RoHS COMPLIANT AND LEAD-FREE. SOLDERABLE PER REFLOW PROFILE SHOWN. EACH REEL & BAG IS MARKED WITH RoHS COMPLIANT LABEL (P/N 9100-117-0852-99) OR EQUIVALENT.
6. THIS COMPONENT IS AN ELECTROSTATIC DISCHARGE SENSITIVE DEVICE (ESD). MAINTAIN ALL PRECAUTIONARY MEASURES DURING ASSEMBLY, HANDLING AND STORAGE IN ACCORDANCE WITH IPC-A-610
7. DIALIGHT P/N 597-3612-407F; -402F FOR 20 PIECE SAMPLE STRIP

OPERATING CHARACTERISTICS AT 25°C AMBIENT

PARAMETER	MIN.	TYP.	MAX.	UNITS	TEST CONDITION
FORWARD VOLTAGE		3.3	3.8	V	I _f = 10 mA
REVERSE CURRENT			100	μA	V _r = 5 V
PEAK WAVELENGTH		465		nm	I _f = 10 mA
LUMINOUS INTENSITY	47		220	mcad	I _f = 10 mA
VIEWING ANGLE		50		DEGREE	2q1/2
DOMINANT WAVELENGTH		470			I _f = 10 mA

ABSOLUTE MAXIMUM RATINGS AT 25°C AMBIENT

PARAMETER	GREEN	UNITS
DC FORWARD CURRENT	20	mA
PEAK FORWARD CURRENT (≤ 1/20 DUTY CYCLE, ≤ 1ms PULSE WIDTH)	48	mA
REVERSE VOLTAGE	5	V
OPERATING TEMPERATURE	-40 TO +100	°C
STORAGE TEMPERATURE	-40 TO +110	°C
POWER DISSIPATION	80	mW
DERATE FROM T _a 60° OR HIGHER	0.96	°C

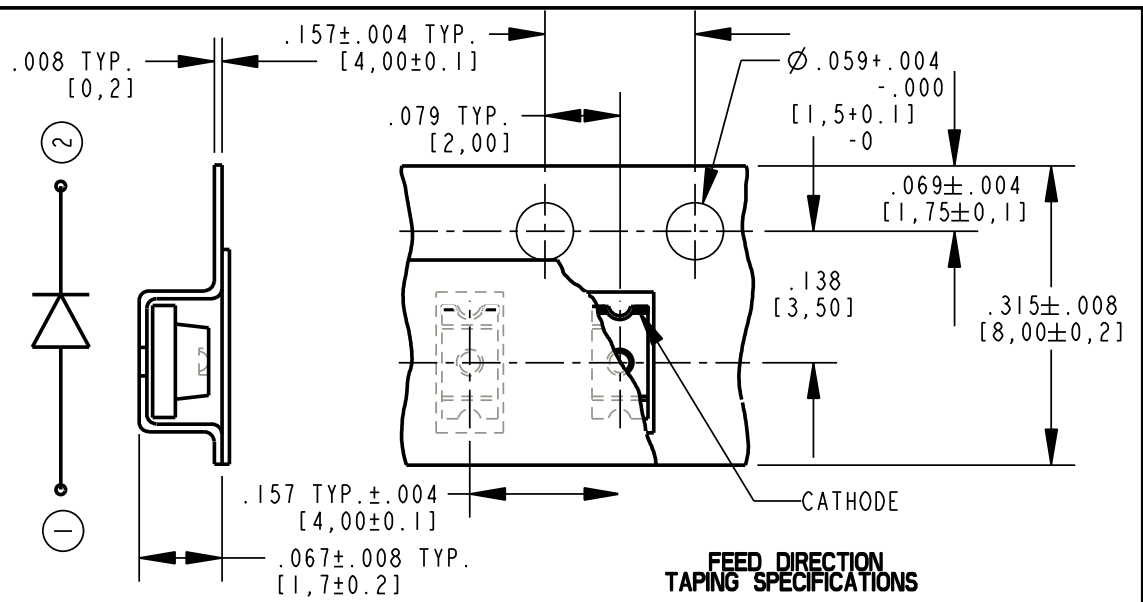

THIS DRAWING AND THE CONTENTS HEREIN ARE CONFIDENTIAL AND THE SOLE PROPERTY OF DIALIGHT. REPRODUCTION OF THIS DRAWING OR CONSTRUCTION OF ANY PARTS WITHIN THIS DRAWING ARE FORBIDDEN WITHOUT THE WRITTEN CONSENT OF DIALIGHT.

SCALE: 24.000 ALL DIM'S IN: INCHES (MM)	DRAWING NUMBER C-17276	REV A
TOLERANCES: UNLESS OTHERWISE SPECIFIED FRACTIONS: ±1/64 DECIMALS (.XX): ±.01 DECIMALS (.XXX): ±.005 DECIMALS (.XXXX): ±.0005 ANGLES: ±1°	TITLE LED, BLUE, SMT 1206 PKG. W/ LENS RoHS COMPLIANT	MATERIAL
FINISH:	Dialight	1501 ROUTE 34 SOUTH FARMINGDALE, NJ 07727
FSCM 83330	SHEET 1 OF 1	FAMILY TABLE: