

X99284-V3
REPLACES

RELEASE NO. PR-21675

V3-22

CATALOG LISTING



ISSUE

2

CHECK

REVISIONS

A C095160

TSM

17JUN99

65N99

CHECK

17JUN99

ANSI Y14.5M-1982 APPLIES

THIS DRAWING COVERS A PROPRIETARY ITEM AND IS THE PROPERTY OF MICRO SWITCH, A DIVISION OF HONEYWELL. THIS DRAWING IS NOT TO BE COPIED OR USED WITHOUT THE APPROVAL OF MICRO SWITCH.

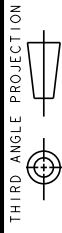

THIRD ANGLE PROJECTION

CHECK

PTC/CAD 2D
DRAWN

TSM 17JUN99

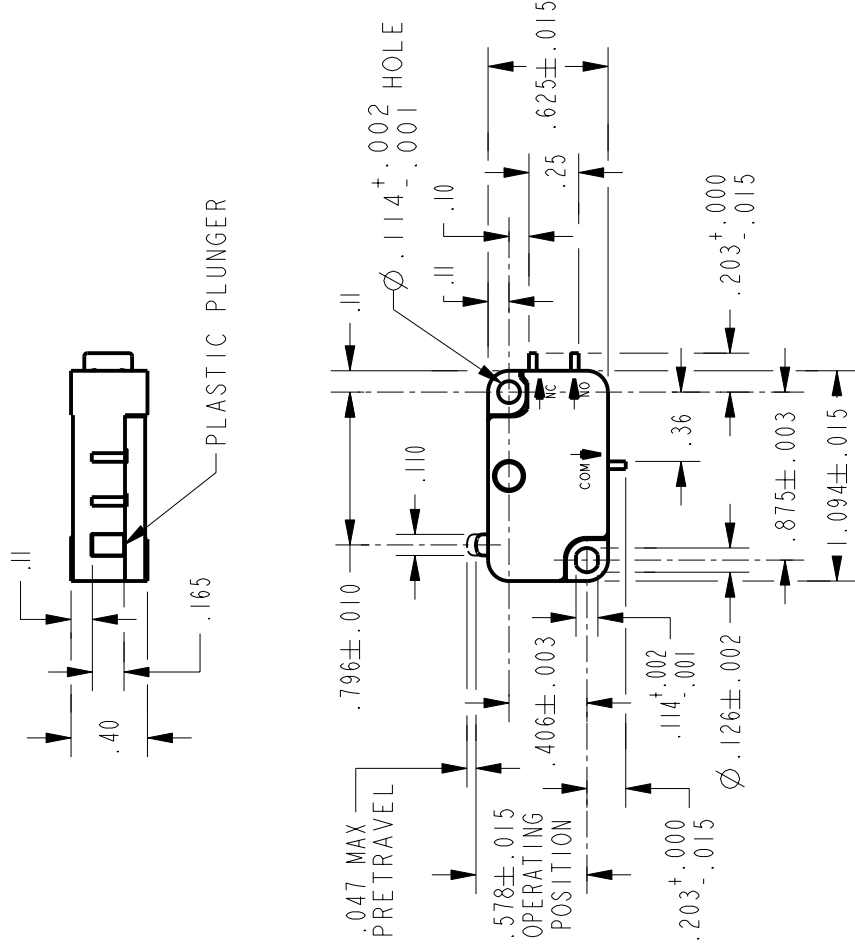

NOTES

- 1 - NO HOLES IN TERMINALS
- 2 - TERMINALS ARE PLATED
- 3 - SWITCH MATERIALS WILL WITHSTAND TEMPERATURE OF 300° F

CHARACTERISTICS

OPERATING FORCE	6 - 14 OZ
RELEASE FORCE	4 OZ MIN
DIFFERENTIAL TRAVEL	.006 - .016
OVERTRAVEL	.040 MIN
FREE POSITION	.625 MAX
RELEASE TRAVEL	.007 MIN

ELECTRICAL DATA

CONTACT ARRANGEMENT

S P D T

L83 15.1A 1/2HP 125, 250 VAC
1/2A 125 VDC, 1/4A 250 VDC
5A 125 VAC "L"

SCALE FULL

DO NOT SCALE PRINT

UNLESS OTHERWISE SPECIFIED TOLERANCES ARE

ONE PLACE (.0)

TWO PLACE (.00)

THREE PLACE (.000)

ANGLES

±

WEIGHT .015 LB